



Order number: 56270334  
Your Reference: SSR75355826  
03/04/19 05:14



NSW LRS - Title Search

NEW SOUTH WALES LAND REGISTRY SERVICES - TITLE SEARCH  
-----

FOLIO: 4/SP92069  
-----

SEARCH DATE -----	TIME -----	EDITION NO -----	DATE -----
3/4/2019	5:13 AM	3	8/9/2018

NO CERTIFICATE OF TITLE HAS ISSUED FOR THE CURRENT EDITION OF THIS FOLIO.  
CONTROL OF THE RIGHT TO DEAL IS HELD BY WESTPAC BANKING CORPORATION.

LAND  
-----

LOT 4 IN STRATA PLAN 92069  
AT DAPTO  
LOCAL GOVERNMENT AREA WOLLONGONG

FIRST SCHEDULE  
-----

[REDACTED]  
AS JOINT TENANTS

(T AM317112)

SECOND SCHEDULE (2 NOTIFICATIONS)  
-----

- 1 INTERESTS RECORDED ON REGISTER FOLIO CP/SP92069
- 2 AM317113 MORTGAGE TO WESTPAC BANKING CORPORATION

NOTATIONS  
-----

UNREGISTERED DEALINGS: NIL

\*\*\* END OF SEARCH \*\*\*

© Office of the Registrar-General 2019

SAI Global Property Division an approved NSW Information Broker hereby certifies that the information contained in this document has been provided electronically by the Registrar General in accordance with section 96B(2) of the Real Property Act 1900.

**CONNECTIONS**

FROM - TO (LINE)	BEARING & DISTANCE
PM45639 - A	47°27'10" - 155.22
A - B	46°30'10" - 32.11
B - C	84°15'05" - 25.17
C - D	75°41'25" - 12.66
D - E	10°11'10" - 11.575
E - F	116°13'05" - 29.46
F - G	172°03'50" - 14.205
G - H	126°02'05" - 35.975
H - I	226°44'10" - 127.12
I - J	146°59'55" - 4.485
J - K	219°04'05" - 111.775
K - L	359°43'45" - 57.91
L - M	17°41'25" - 2.07
M - N	283°51'35" - 34.14
N - O	6°01'05" - 6.215
O - P	212°03'55" - 26.89
P - Q	283°39'10" - 18.805
Q - R	136°29'35" - 12.145
R - S	229°20'05" - 24.32
S - T	212°37'05" - 27.02
T - SSM26187	279°42'10" - 165.955
H - PM45638	120°39'25" - 365.542

**SCHEDULE OF MARKS**

MARK	ORIGIN
A	RM GIP FD DP614436
B	DHW ON CONCRETE SURROUND OF PIT PLACED
C	RM GIP FD DP1212343
D	RM GIP FD DP1212343
E	STAINLESS STEEL PIN & DISC IN PATH (H551162) PLACED
F	DHW IN CONC. FOOTING PLACED
G	RM GIP FD DP614436
H	RM GIP FD DP1212343
I	STAR PICKET IN CONC. PLACED
J	RM GIP FD (NOW GONE) DP1212343
K	RM GIP FD 10312-3000
L	GIP PLACED
M	RM GIP FD 10312-3000
N	RM GIP FD DP614436
O	DHW IN KERB PLACED
P	RM DHW ON CONCRETE SURROUND OF PIT FD DP228204
Q	DHW IN KERB PLACED
R	RM GIP FD DP1216230
S	RM GIP FD DP1216230
T	RM GIP FD DP228204

Add column for likely effect of development on the mark eg Status Impacted  
Safe etc

Example of Deposited Plan for Survey Information Only - Preservation of Survey Infrastructure Only. Roads and Maritime Services requirements regarding placement of additional cadastral reference marks to maintain the integrity of the cadastre.

Connections to be completed in closed loops. Close calculations to be supplied.

NOT INVESTIGATED IN LPI. SURVEY INFORMATION ONLY. NOT TO BE USED FOR TITLE DESCRIPTION

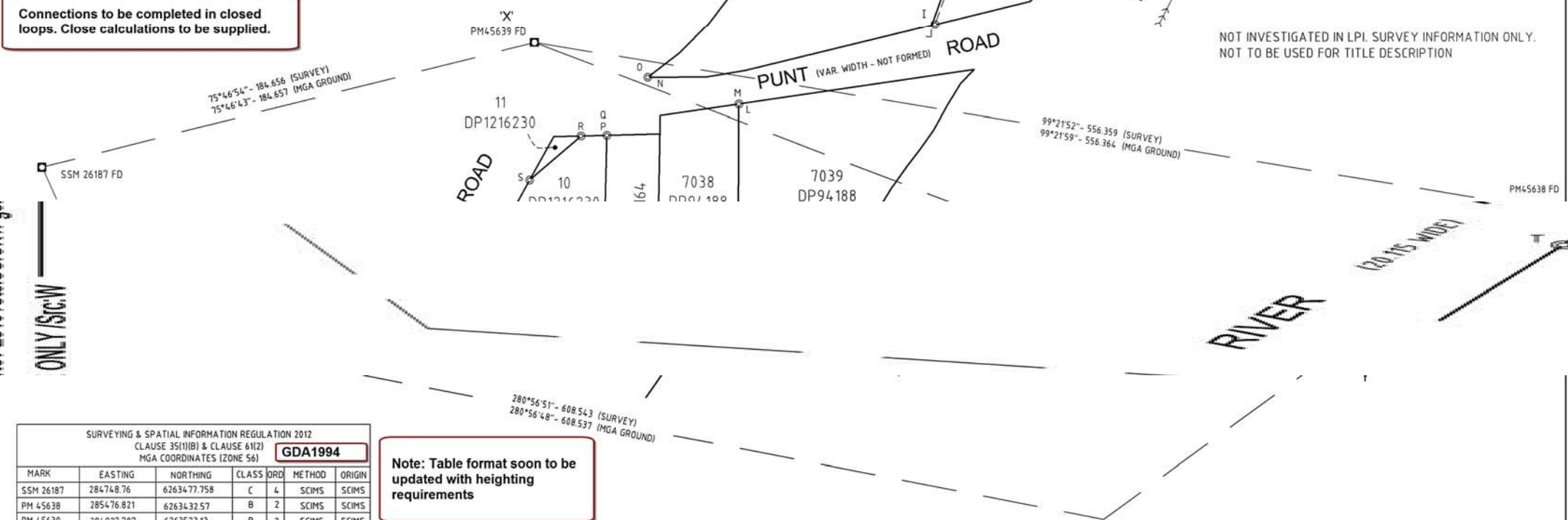

**SURVEYING & SPATIAL INFORMATION REGULATION 2012**  
 CLAUSE 35(1)(B) & CLAUSE 6(1)(2)  
 MGA COORDINATES (ZONE 56) **GDA1994**

MARK	EASTING	NORTHING	CLASS	ORD	METHOD	ORIGIN
SSM 26187	284748.76	6263477.758	C	4	SCIMS	SCIMS
PM 45638	285476.821	6263432.57	B	2	SCIMS	SCIMS
PM 45639	284927.787	6263523.13	B	2	SCIMS	SCIMS
PM 57164	285346.32	6263362.182	B	2	SCIMS	SCIMS

SOURCE: LAND AND PROPERTY INFORMATION (SCIMS) - 12/10/2016  
 COMBINED SEA LEVEL & SCALE FACTOR 1.00016

Note: Table format soon to be updated with heighting requirements

14 March 2017

Surveyor: MATTHEW JAMES CLARKE  
 Date of Survey: 29 SEPTEMBER, 2016  
 Surveyor's Ref: 2016S244  
 Add: RMS POSI Ref and approval Ref information

**PLAN OF SURVEY INFORMATION ONLY**  
 Add:  
 - Preservation of Survey Infrastructure  
 - location information

LGA: PENRITH  
 Locality: EMU PLAINS  
 Subdivision No: N/A  
 Lengths are in metres. Reduction Ratio 1:1000

Registered  
 22.11.2016

**DP1226157**

ALL /Prt:24-Nov-2016 04:30 /Seq:1 of 2  
 Nov-2016 /S/S:SC OK /Pg:1  
 Ref:ipi:epian-epian FOR SURVEYORS USE  
 Req:R827917 /Doc:DP 1226157 P /Rev:23